



CIRCULAR STORAGE TABLE

Type: SKA 01



Strojírna Pálava Maxima s.r.o.

DESÁTKOVÁ 124/15, 623 00 BRNO KOHOUTOVICE
Manufactory: TOVÁRNÍ 34, 679 32 SVITÁVKA, CZECH REPUBLIC
tel: +420 - 516 453 834, fax: +420 - 516 453 834
e-mail: info@s-palava.cz; www.s-palava.cz

CIRCULAR STORAGE TABLE
Type : SKA 01

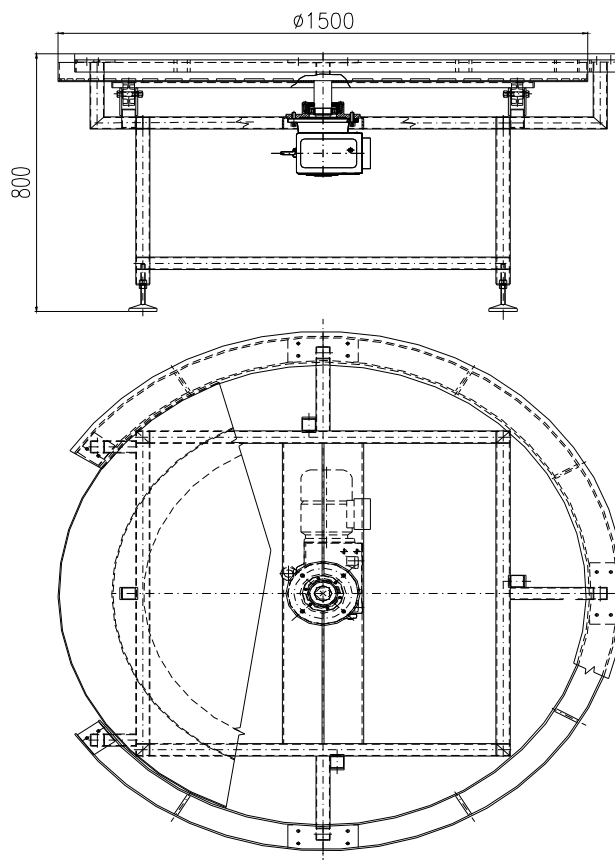

The circular storage table is placed at the end of the conveyor for meat cutting and is used to cut meat sorting. The skeleton is welded from quadratic thin-walled profiles and has adjustable feet. The rotary bowl (\varnothing 1500 mm) is driven by gear unit and is sandwiched with Orbilan desks.

Technical data

| | |
|-----------------|-----------------------------|
| Bowl's diameter | \varnothing 1300, 1500 mm |
| Height | 800 mm |
| Turning speed | 7,4 turns/min. |
| Gear unit | NORD SK 9016.1 AF-71 L/4 TF |
| Power | 0,37 kW |
| Torsion moment | 748 Nm |